

Office/Retail/Personal Services California Avenue District Sublease 150 Grant Ave., #D, Palo Alto

Potential
Startup
Space



HIGHLIGHTS

- ◆ **Size:** ±2,006 Sq. Ft. air conditioned end cap unit on ground floor
- ◆ **Layout:** 15' clear height in open area, 2 rollup doors, office, restroom
- ◆ **Commute:** next to Caltrain & easy access to Highways 101 & 280
- ◆ **California Avenue District:** numerous nearby cafes & shops
- ◆ **Parking:** 3.4/1,000 onsite parking with adjacent public parking
- ◆ **Uses:** office, retail, personal service, educational (CC2 zoning)
- ◆ **Term:** available Jan. 2012 – Nov. 2013 or longer through landlord



Mike L. Meffert
Alhouse Deaton
Management & Leasing, Inc.

Stanford Financial Square
2600 El Camino Real, Suite 200
Palo Alto, CA 94306
Cell Ph. (650) 207-4754
Fax. (650) 852-0316

mmeffert@alhousedeaton.com

DRE #01361294

Office/Retail/Personal Services California Avenue District Sublease 150 Grant Ave., #D, Palo Alto

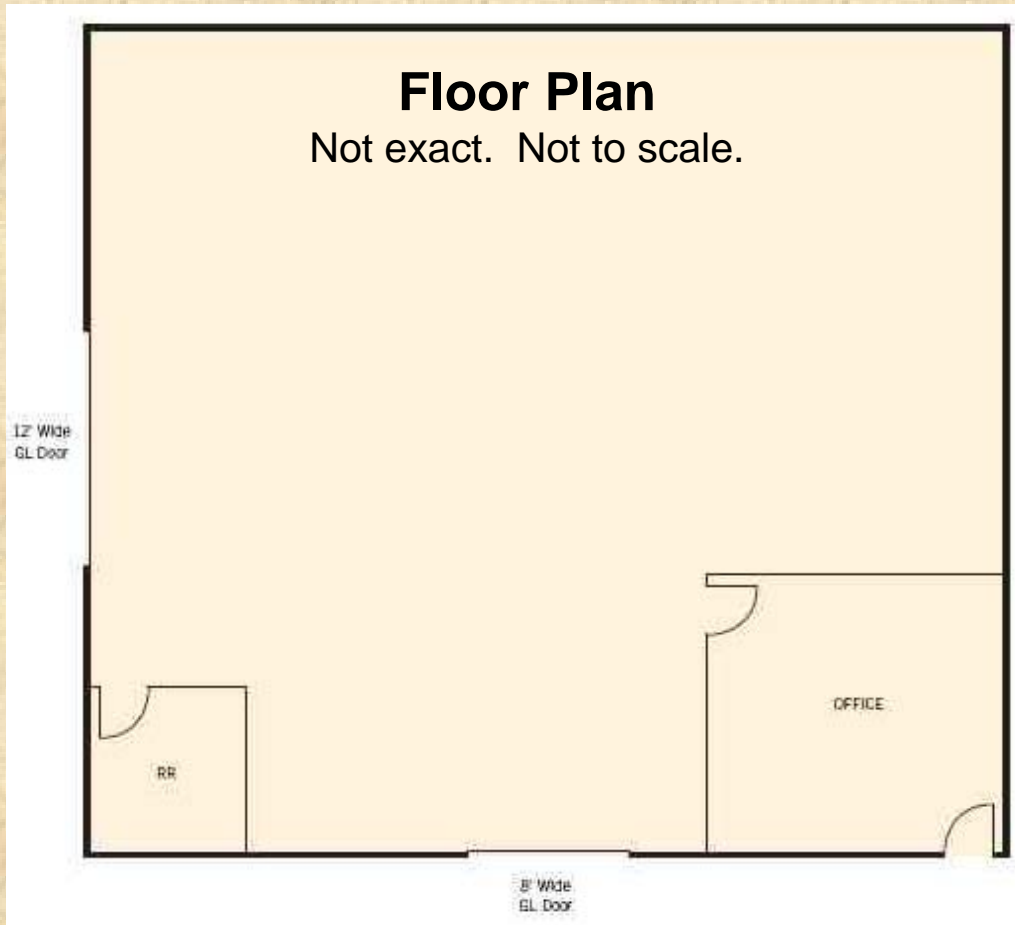

The information contained herein has been obtained by sources we deem reliable. We have no reason to doubt its accuracy, but we do not guarantee it.